

Wohnflächen

Projekt: + 1101 BV Alwang Sanierung Dachgeschoss
 Ersteller: martin
 Datum / Zeit: 24.11.2011 / 17:47
 Hinweis:

Bezeichnung	Funktion	Nr	Abmessungen	Wohnfläche [m ²]
-------------	----------	----	-------------	------------------------------

2. Obergeschoss

02_002

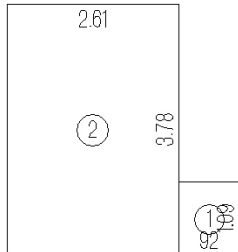

Büro/ Kind

1	1.09*0.92	1,00
2	3.78*2.61	9,85
Summe		10,85

02_003

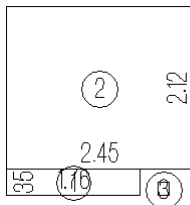

Bad

1	1.76*0.35	0,62
2	2.45*2.12	5,18
3	0.17*0.15	0,02
Summe		5,82

02_004

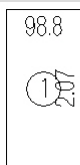

WC

1	2.07*0.99	2,04
Summe		2,04

02_005

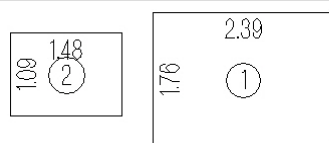

Diele/Flur

1	2.39*1.76	4,20
2	1.48*1.09	1,61
Summe		5,81

02_006

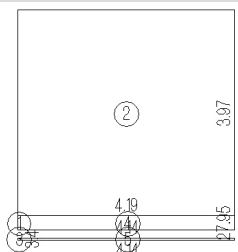

Schlafen

1	0.28*0.05	0,01
2	4.19*3.97	16,62
3	0.05*0.03	0,00
4	0.5*(4.14*0.28)	0,58
5	0.5*(4.14*0.03)	0,07
Summe		17,28

Wohnflächen

Projekt: + 1101 BV Alwang Sanierung Dachgeschoss
 Ersteller: martin
 Datum / Zeit: 24.11.2011 / 17:47
 Hinweis:

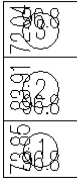
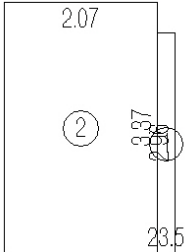
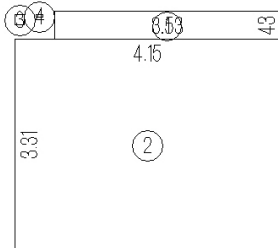
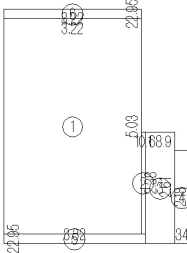
Bezeichnung	Funktion	Nr	Abmessungen	Wohnfläche [m ²]
02_007				
	AR	1	0.97*0.74	0,71
		2	0.5*(0.97*0.84)	0,41
		3	0*(0.97*0.72)	0,00
			Summe	1,12
02_009				
	Kochen	1	2.96*0.24	0,70
		2	3.37*2.07	6,97
			Summe	7,67
02_010				
	Essen	1	3.53*0.43	1,52
		2	4.15*3.31	13,72
		3	0.17*0.15	0,02
		4	0.11*0.04	0,00
			Summe	15,26
02_011				
	Wohnen	1	5.03*3.22	16,18
		2	2.38*0.10	0,24
		3	2.61*0.69	1,80
		4	2.18*0.34	0,74
		5	0.5*(3.32*0.23)	0,38
		6	0.5*(3.22*0.23)	0,37
			Summe	19,71
Summe 2. Obergeschoss				85,56
Gesamtsumme				85,56